

# INSTALLATION INSTRUCTIONS

## SERIES 487 SDS / ADS STOCK SLIDING DOORS



---

Phone: (800) 421-6144 • Fax: (866) 921-0531  
[crlaurence.com](http://crlaurence.com) • [usalum.com](http://usalum.com) • [crl-arch.com](http://crl-arch.com)

---

# GENERAL INSTALLATION NOTES

## Recommended Guidelines For All Installations:

1. **REVIEW CONTRACT DOCUMENTS.** Check shop drawings, installation instructions, architectural drawings, and shipping lists to become thoroughly familiar with the project. The shop drawings take precedence and include specific details for the project. Note any **field verified** notes on the shop drawings prior to installing. The installation instructions are of a general nature and cover most conditions.
2. **INSTALLATION.** All materials are to be installed plumb, level, and true. Install operable windows preglazed only.
3. **BENCH MARKS.** All work should start from bench marks and/or column lines as established by the architectural drawings and the general contractor with guaranteed accuracy. Working from these datum points and lines determine:
  - a) The plane of the wall in reference to offset lines provided on each floor.
  - b) The finish floor lines in reference to bench marks on the outer building columns.
  - c) Mullion spacing from both ends of masonry opening to prevent dimensional build-up of daylight opening.
4. **FIELD WELDING.** All field welding must be adequately shielded to avoid any splatter on glass or aluminum. Results will be unsightly and/or structurally unsound. Advise general contractor and other trades accordingly. All field welds of steel anchors must receive touch-up paint (zinc chromate) to avoid rust.
5. **SURROUNDING CONDITIONS.** Make certain that construction which will receive your materials is in accordance with the contract documents. If not, notify the general contractor in writing and resolve differences before proceeding with work.
6. **ISOLATION OF ALUMINUM.** Aluminum to be placed in direct contact with uncured masonry or incompatible materials should be isolated with a heavy coat of zinc chromate or bituminous paint.
7. **SEALANTS.** Sealants must be compatible with all materials with which they have contact, including other sealant surfaces. Consult with sealant manufacturer for recommendations relative to joint size, shelf life, compatibility, cleaning, priming, tooling, adhesion, etc. It is the responsibility of the **Glazing Contractor** to submit a statement from the sealant manufacturer indicating that glass and glazing materials have been tested for compatibility and adhesion with glazing sealants, and interpreting test results relative to material performance, including recommendations for primers and substrate preparation required to obtain adhesion. The chemical compatibility of all glazing materials and framing sealants with each other and with like materials used in glass fabrication must be established. This is required on every project.
8. **FASTENING.** Within the body of these instructions "fastening" means any method of securing one part to another or to adjacent materials. Only those fasteners used within the system are specified in these instructions. Due to the varying perimeter conditions and performance requirements, perimeter and anchor fasteners are not specified in these instructions. For perimeter and anchor fasteners refer to the shop drawings or consult the fastener supplier.
9. **BUILDING CODES.** Due to the diversity in state/provincial local, and federal laws and codes that govern the design and application of architectural products, it is the responsibility of the individual architect, owner, and installer to assure that products selected for use on projects comply with all the applicable building codes and laws. U.S. Aluminum exercises no control over the use or application of its products, glazing materials, and operating hardware and assumes no responsibility thereof.
10. **EXPANSION JOINTS.** Expansion joints and perimeter seals shown in these instructions and in the shop drawings are shown at normal size. Actual dimensions may vary due to perimeter conditions and/or difference in metal temperature between the time of fabrication and the time of installation. Gaps between expansion members should be based on temperature at time of installation.
11. **COORDINATION WITH OTHER TRADES.** Coordinate with the general contractor any sequence with other trades which offset curtain wall installation (i.e. fire proofing, back-up walls, partitions, ceilings, mechanical ducts, converters, etc.)
12. **CARE AND MAINTENANCE.** Final cleaning of exposed aluminum surfaces should be done in accordance with AAMA 609.1 for anodized aluminum and 610.1 for painted aluminum.

# HANDLING, STORAGE, AND PROTECTION OF ALUMINUM

The following precautions are recommended to protect the material against damage. Following these precautions will help ensure early acceptance of your products and workmanship.

- A. HANDLE CAREFULLY.**  
All aluminum materials at job site must be stored in a safe place, well removed from possible damage by other trades. Cardboard wrapped or paper interleaved materials must be kept dry.
- B. CHECK ARRIVING MATERIALS.**  
Check for quantities and keep records of where various materials are stored.
- C. KEEP MATERIALS AWAY FROM WATER, MUD, AND SPRAY.**  
Prevent cement, plaster or other materials from damaging the finish.
- D. PROTECT THE MATERIALS AFTER ERECTION.**  
Protect erected frame with polyethylene or canvas splatter screen. Cement, plaster, terrazzo, other alkaline solutions, and acid based materials used to clean masonry are harmful to the finish. *If any of these materials come in contact with the aluminum, immediately remove with water and mild soap.*

**IMPORTANT: READ THIS MANUAL THOROUGHLY BEFORE BEGINNING INSTALLATION**

## TABLE OF CONTENTS

GENERAL INSTALLATION NOTES .....	2
HANDLING, STORAGE, AND PROTECTION OF ALUMINUM .....	3
DOOR KIT OPTIONS AND DIMENSIONS .....	4
Standard Sliding Door Kits .....	4
Glass Stop with Gasket Kits .....	4
OPTIONAL DOOR SIZE MODIFICATION .....	5 - 6
Width Reduction .....	5
Height Reduction .....	6
FLUSH LOCK INSTALLATION .....	7
A/R 1850 LOCK INSTALLATION .....	8
GLAZING .....	9
Glass Sizing and Glazing Components .....	9
Door Glazing Sequence .....	9

## DOOR OPTIONS AND DIMENSIONS

Series 487 Door Kits are designed to fit Series 487 Stock Frame Kits with no modification. However, both the frames and the doors are easily customized. Standard 487 Door Kits are available in 11 and 22 finishes and sizes listed below. Doors are fabricated for lock options shown. Lock hardware is ordered separately and installed by customer. Doors are shipped assembled and may be disassembled and cut to size. Glass Stops are included and use same glazing gaskets at the fixed lites, ordered separately.

### STANDARD SLIDING DOOR

ADS Kit Part No.	SDS Kit Part No.	Net Door Width	Net Door Height	No Lock	A/R 1850 Lock	Flush Lock
487ADS310_	487SDS310_	37-15/16" (964 mm)	119-15/16" (3046 mm)	X		
487ADS310A_		37-15/16" (964 mm)	119-15/16" (3046 mm)		X	
487ADS310F_	487SDS310F_	37-15/16" (964 mm)	119-15/16" (3046 mm)			X
487ADS3610_	487SDS3610_	43-15/16" (1116 mm)	119-15/16" (3046 mm)	X		
487ADS3610A_		43-15/16" (1116 mm)	119-15/16" (3046 mm)		X	
487ADS3610F_	487SDS3610F_	43-15/16" (1116 mm)	119-15/16" (3046 mm)			X
487ADS368_	487SDS368_	43-15/16" (1116 mm)	95-15/16" (2437 mm)	X		
487ADS368A_		43-15/16" (1116 mm)	95-15/16" (2437 mm)		X	
487ADS368F_	487SDS368F_	43-15/16" (1116 mm)	95-15/16" (2437 mm)			X
487ADS38_	487SDS38_	37-15/16" (964 mm)	95-15/16" (2437 mm)	X		
487ADS38A_		37-15/16" (964 mm)	95-15/16" (2437 mm)		X	
487ADS38F_	487SDS38F_	37-15/16" (964 mm)	95-15/16" (2437 mm)			X

487ADS\_ and 487SDS\_  
Top and Bottom Rails

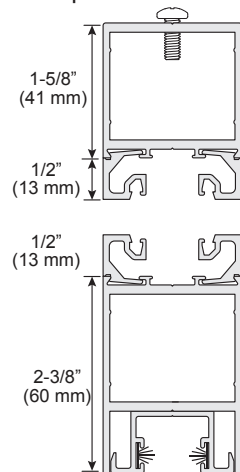

487ADS\_ Vertical Stiles

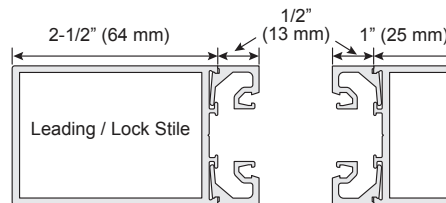

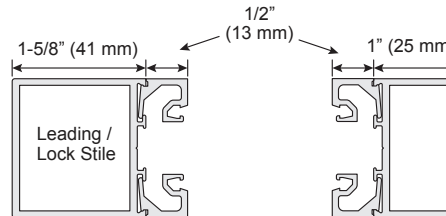

487SDS\_ Vertical Stiles

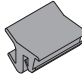
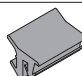

## GLAZING GASKETS

NOTE: Glazing Gaskets ordered separately. See below for ordering information.

NP225  Gasket for 1/4" Glass	100 FT ROLL VINYL CAT. NO.	100 FT ROLL SILICONE CAT. NO.	500 FT ROLL VINYL CAT. NO.	100 FT ROLL SILICONE CAT. NO.	COLOR	APPLICATION
	NP225VC	NP225SC	NP225V	NP225S	Black	for 1/4" (6 mm) Glass
NP238  Gasket for 1/2", 3/8" Glass	NP225VCGRY	NP225SCGRY	NP225VGRY	NP225SGRY	Grey	for 1/4" (6 mm) Glass
	NP238VC	---	NP238V	---	Black	*for 3/8" and 1/2" (10 and 12 mm) Glass
NP563  Gasket for 1/2", 9/16" Glass	NP238VCGRY	---	NP238VGRY	---	Grey	*for 3/8" and 1/2" (10 and 12 mm) Glass
	NP563VC	---	NP563V	---	Black	*for 1/2" and 9/16" (12 and 14 mm) Glass
	NP563VCGRY	---	NP563VGRY	---	Grey	*for 1/2" and 9/16" (12 and 14 mm) Glass

\*NOTE: When glazing with 1/2" (12 mm) glass use Cat. No. NP238 on one side and NP563 on the opposite side.

## OPTIONAL DOOR SIZE MODIFICATION

The width and/or height of the Standard 487 Door may be reduced to fit changes made to your Sliding Door Frame Kit. Reference the final dimensions of the frame to ensure your door aligns properly. Partial disassembly, fabrication and reassembly of the door is required.

### Width Reduction

- ① Remove screws at end of Top and Bottom Rails.
- ② Remove Rear Stile (without lock or pull).
- ③ Remove Guide Track from Bottom Rail.
- ④ Cut same amount from end of Top and Bottom Rails and Guide Track.
- ⑤ Drill holes in Top and Bottom Rails.
- ⑥ Reverse Steps 1 - 3 to reassemble.

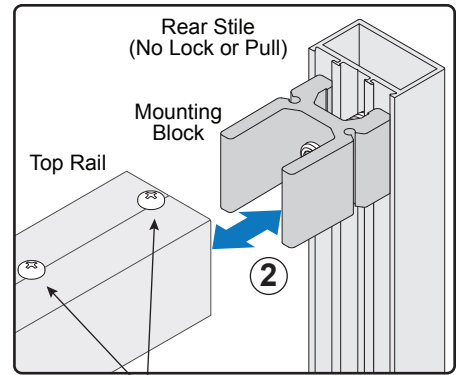

NOTE: Mounting Screws factory installed. Remove and use to install Roller Brackets included in Hardware Kit.

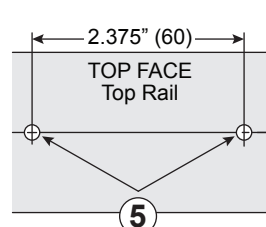
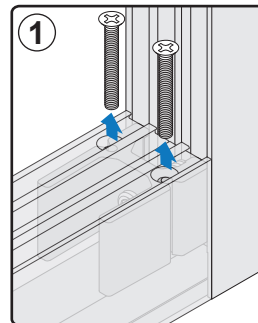
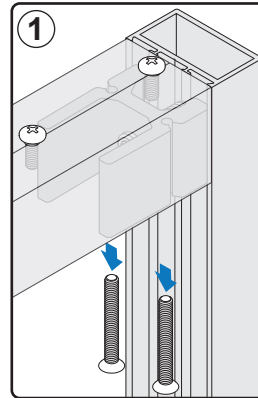
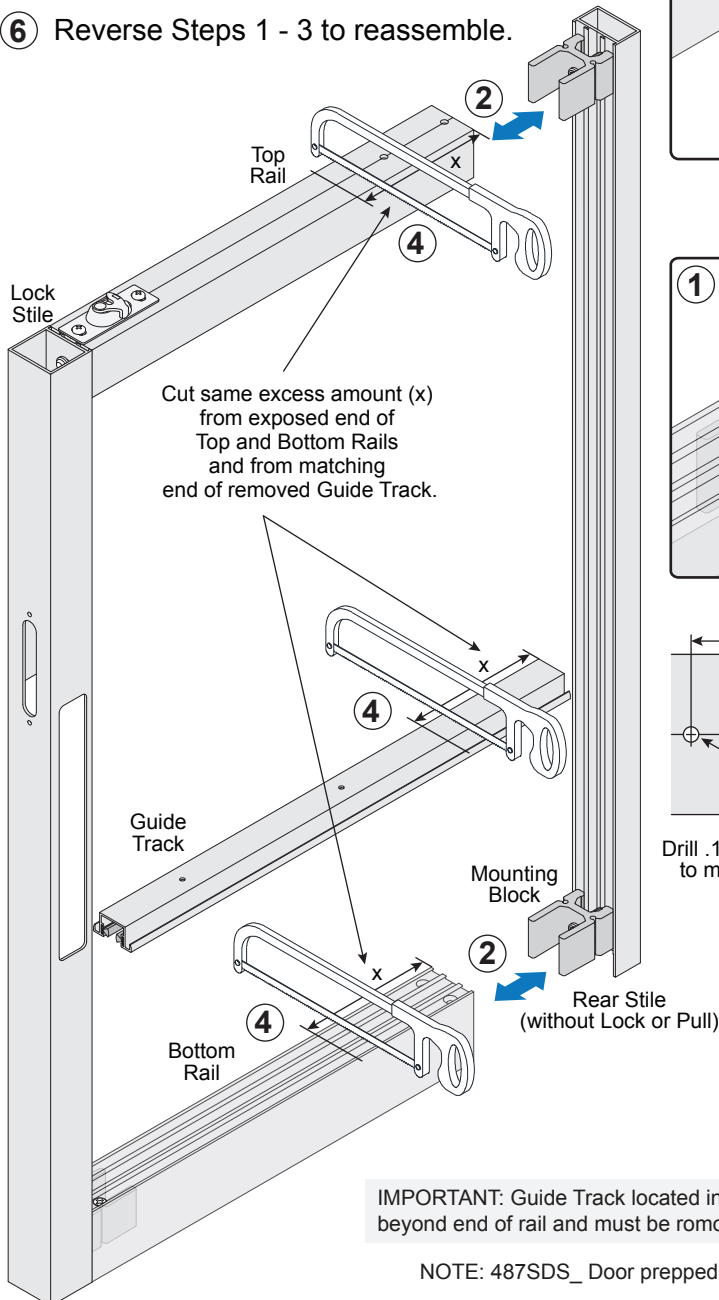
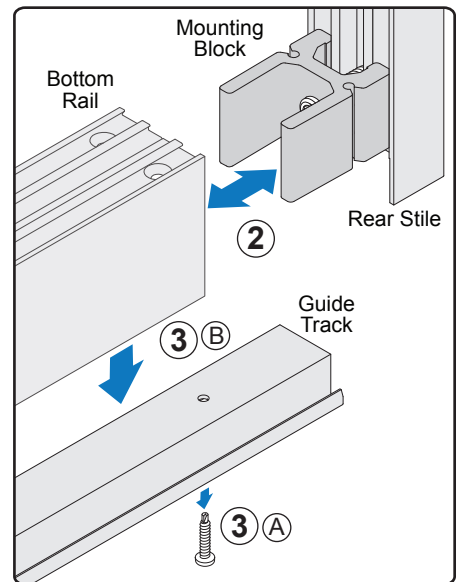

Drill .16" (4) Diameter Holes to mount Roller Bracket.

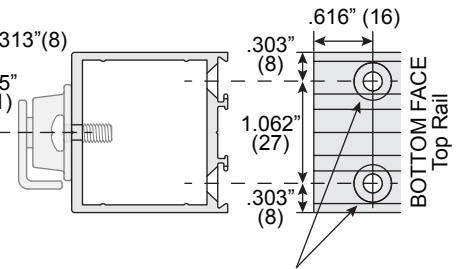

⑤ Drill .19" (5) Holes with Countersink for #10 Screws to attach to Mounting Blocks.

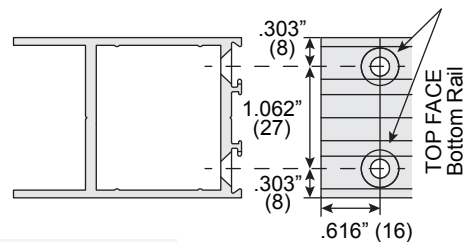

IMPORTANT: Guide Track located in Bottom Rail extends beyond end of rail and must be removed and cut separately.

NOTE: 487SDS\_Door prepped for Flush Lock shown.

# OPTIONAL DOOR SIZE MODIFICATION (CONTINUED)

## Height Reduction

IMPORTANT: Only cut top end of door stiles.

- ① Remove screws at both ends of Top and Bottom Rails.
- ② Remove Lock and Rear Stiles.
- ③ Remove top Mounting Blocks.
- ④ Cut same amount from top end of both stiles.
- ⑤ Drill holes in top end of both stiles.
- ⑥ Reverse Steps 1 - 3 to reassemble.

NOTE: Mounting Screws factory installed. Remove and use to install Roller Brackets included in Hardware Kit.

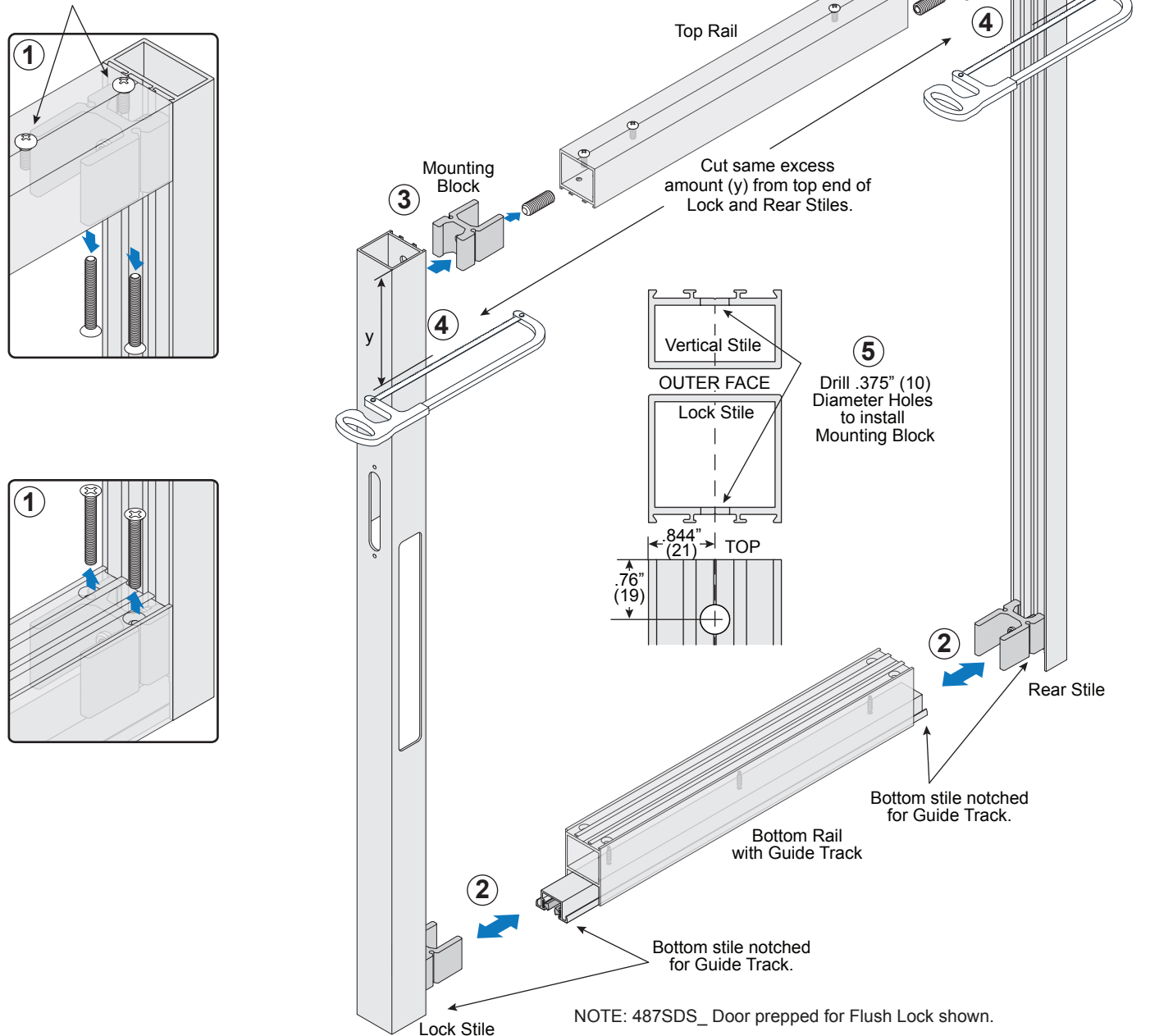

## FLUSH LOCK INSTALLATION

- ① Insert lock mechanism through cutout in side face of lock stile and align with oval cutout.
- ② Secure with screws included with lock.
- ③ Align interior and exterior flush handles. Secure with included screws.

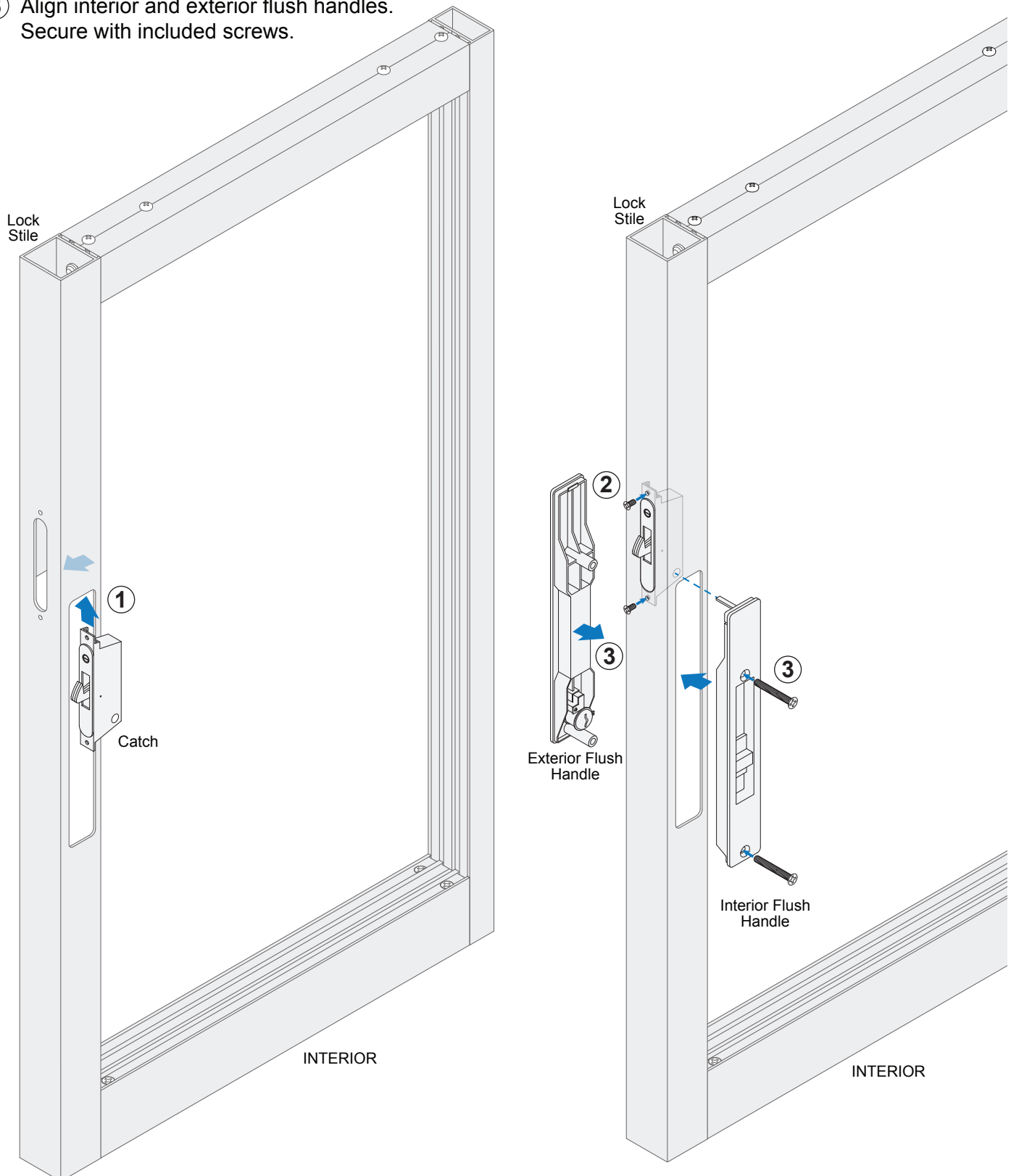

## A/R 1850 LOCK INSTALLATION

- ① Fasten A/R 1850 lock body to lock stile with included standoffs and screws.
- ② Install cylinder and trim.
- ③ Install face plate with included screws.

NOTE: Customer to install and prep for desired handle.

NOTE: 487ADS\_ Doors use a wider lock stile. Do not install A/R 1850 Locks on 487SDS\_ Doors.

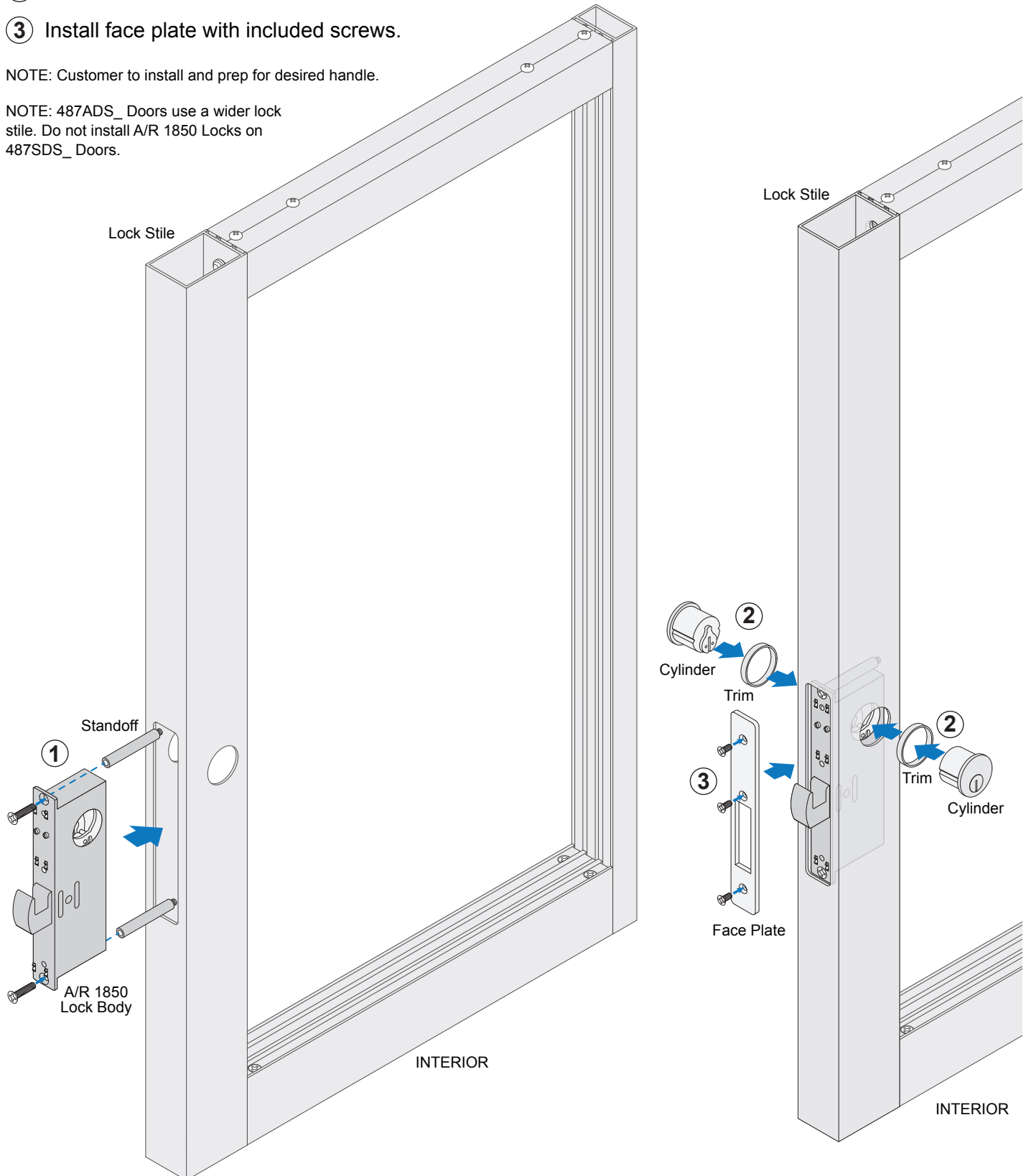



## GLAZING

### Glass Sizing and Glazing Components

GLASS SIZE = D.L.O. + 5/8" or 5/16" GLASS BITE EACH POCKET

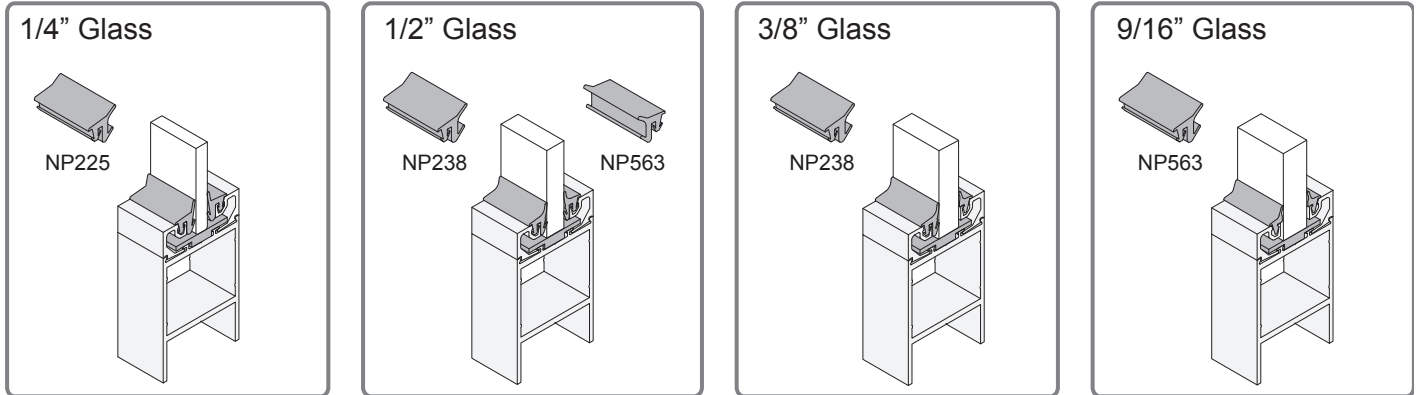

### Door Glazing Sequence

Important: Maximum 200 lbs (91 kg) each Door.

NOTE: Glass Stops are included with the door. Gaskets are ordered separately. See Page 4 for details. with Vertical Glass Stops run through.

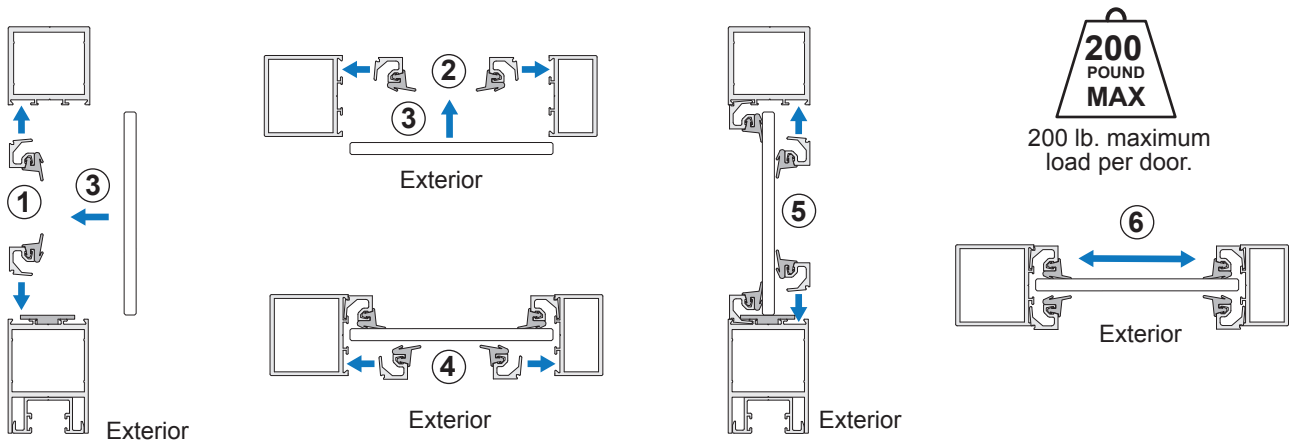

- ① Install Interior Vertical Glass Stops and Gaskets.
- ② Install Interior Horizontal Glass Stops and Gaskets.
- ③ Place glass.
- ④ Install Exterior Vertical Glass Stops and Gaskets.
- ⑤ Install Exterior Horizontal Glass Stops and Gaskets.
- ⑥ Center glass.

NOTE: After the door size has been completely modified, see the 11M0384 Sliding Door Frame Installation Manual to hang the door. Door may be glazed before or after installation.